

MINNESOTA

Clay County District Court

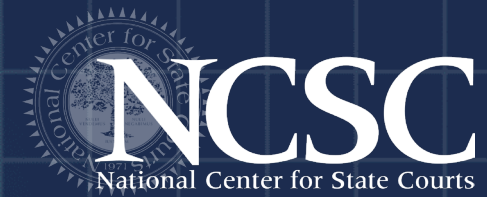

LOCATION	Moorhead, Minnesota
COURT JURISDICTIONS	Criminal, Civil, Domestic/Family, Juvenile, Small Claims, Traffic, Probate, Specialty
PROJECT STATUS	Completed February 2022

PROJECT VISION

This renovation aimed to transform an obsolete courtroom into a versatile space conducive to diverse functions encompassing court proceedings, meetings, and presentations.

PROJECT DETAILS

Constructed in 1954, the Clay County Courthouse had been operating with four courtrooms and one hearing room shared between four judges and one judicial referee, along with visiting judges and a child support magistrate. However, the pandemic in 2020 heightened the demand for increased and more adaptable space. To meet the demand, the court decided to repurpose the unused Clay County Commission Board Room on the third floor into a flexible, multi-use courtroom (Courtroom 6). Parameters for the space included providing an open floorplan capable of accommodating various sizes and types of hearings in addition to a movable jury box and modular furniture to maintain the space's versatility. The modular furniture was designed and constructed by a local individual to the precise specifications of the court. Three large screens and a projector were strategically placed to allow for the presentation of digital evidence. While many of the other courtrooms in the building do not have natural light, this space was fortunate to have multiple windows. The renovated space is bright, open, and offers a flexible environment conducive to the diverse needs of its users.

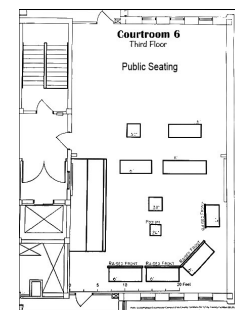

MINNESOTA

Clay County District Court

ENHANCING OPERATIONS AND THE OVERALL BUILDING EXPERIENCE

Courtroom 6 has allowed a judicial referee to conduct hearings in the updated space. Previously, the referee was conducting hearings in a courtroom in dire need of an update, especially related to the recording equipment. Furthermore, one of the other five courtrooms five (5) is not a full courtroom, which makes its use quite limited. With the addition of Courtroom 6, the district court judges and the judicial referee can utilize it and modify courtroom assignments to fit the needs of the cases on the docket on any day. In addition, if a visiting judge is seated in the county, the remaining judicial staff can conduct court without being a courtroom short for availability. Finally, Courtroom 6 is flexible so it can be adapted for a court trial or other specific court hearings far easier and more efficiently than any of the other existing courtrooms.

